

Vacation rental Alsace

"Closerie de la Collégiale St Martin - CA"



Apartment-Flat 3rd floor, shared entrance, in(on) a(an) Luxury Tudor style house 3 floors

Setting : characteristic, picturesque

Capacity : 4 person(s)

Bedroom(s) : 1

Room(s) : 3



Meublés de Tourisme (3 stars)

Colmar - Upper Rhine (68) - Alsace

France

Reservation : +33 (0) 3 89 41 65 79 (France)

Advert No. 41458

www.iha.com



>> VACATION RENTALS

Internet
Holiday
Ads



Internet
Holiday
Ads



DIRECT BY OWNERS

Vacation rental



Apartment-Flat 3rd floor, shared entrance, in(on) a(an) Luxury Tudor style house 3 floors

- **Ideal for all age groups, family**
- **View :** city, square, monument, pedestrianized street
- **Setting :** characteristic, picturesque
- **Exposure :** South-west

Goodies

- **baby equipment :**
High chair, infant tub, baby potty



sitting room

Surroundings & location



Leisure

- **Leisure activities less than 12 miles :**

Alpine skiing, cross-country skiing, ski-trekking, snowboarding, ice-skating, bathing, canoeing, golf, tennis, squash, riding school, pony club, pathway/broadwalk, hiking, mountain bike (path), boat trips, horse-drawn carriage, horse trekking, skate board (ramps), race track, ten-pin bowling, fishing

- **Supervised :**

Ski school, kids ski area, tennis school, riding school

- **Attractions and relaxation :**

Bar/pub, discotheque, restaurant, movie theater, park and garden, leisure park, zoo/ animal park, exhibition center, art gallery, historical site, museum, theater, opera house, festivals, antiques & bric-a-brac, local craftstore, cellar and wine tasting, casino, sauna, steam baths, beauticians, Bio farm

Surroundings

- **Locality :**

- Ski slopes 18.5mi.
- Ski lifts 18.5mi.
- Ice skating rink 1.85mi.
- Heated swimming pool 1.25mi.
- Public swimming pool 1.25mi.
- Public tennis court 1.25mi.
- 18 hole golf course 6mi.
- Flying clubs 3mi.
- Watersports centre 1.85mi.
- River 1.85mi.
- Mountain range 9mi.
- Marina 1.85mi.

- **Amenities :**

- Downtown <165'
- Bus stop / bus station 330'
- Ski bus pick up point 0.5mi.
- Bike/mountain bike hire 660'
- Car rental 0.3mi.
- Boat rental 1.85mi.
- Ski hire store 9mi.
- Breadstore <165'
- Caterer 330'
- Local stores <165'
- Supermarket 330'
- High class retailers <165'
- Hairdressing salon 330'
- Internet cafe 330'
- Mail office 990'
- Bank <165'
- ATM <165'
- Drugstore <165'
- Doctor <165'
- Hospital 0.93mi.



sitting room



Interior layout



view from the sitting-room

Interior

- **Receive up to guest(s) :**

4 person(s) - 4 adults

- **Liveable floor area :**

530 Sq.ft.

- **Interior layout :**

3 Room(s), 1 bedroom(s), 1 bathroom, 1 washroom, sitting room 194 Sq.ft., large separate kitchen, dining area

- **Sleeps - bed(s) :**

1 full bed(s), 1 sleeper sofa(s) 2 pers, 1 baby cradle

- **Guest facilities :**

T.V., DVD player, book collection, t.v points, cable/satellite, high speed internet access, wifi (wireless internet access), cupboard, Hanging wardrobe, hair dryer, mobile cool air fan, central heating, Drapes, Double glazed, Rolling shutters, entry phone system

- **Appliances :**

Crockery/flatware, kitchen utensils, cafetiere, electric coffee maker, electric kettle, toaster, juicer, gaz stove, oven, micro-wave oven, extractor hood, refridgerator, deep freeze, washing machine, vacuum cleaner, iron, ironing board

Exterior

- **Outside accommodation :**

Roof terrace 860 Sq.ft., sundeck, pergola 270 Sq.ft.

- **Outside amenities :**

BBQ, yard table(s), 10 yard seat(s), parasol, 3 sun recliner(s)



bedroom

Services

- **washing :**

Sheets (1 X / per week), Towels (1 X / per week), Linen (1 X / per week), Comforter(s), Pillows

- **Single family home :**

Serviced supplement (1 X / per week +\$41 *), Cleaning on departure

For your guidance

- **For your guidance**

Kids welcome

Pets accepted under certain conditions (ask the owner)

Cell phone network coverage

Water : hot/cold

Local voltage supply : 220-240V / 50Hz

Electricity supply : mains



view from the sitting-room

Floor plan

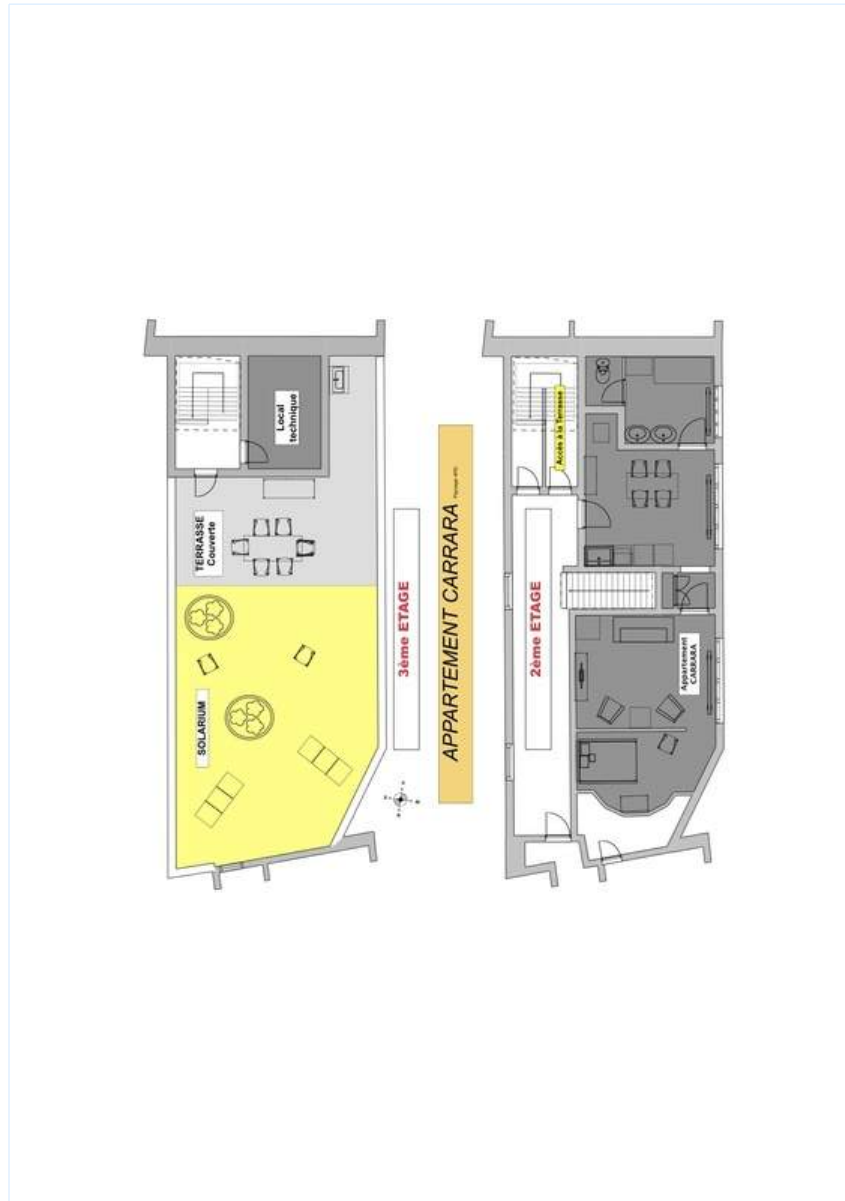

www.ihh.com

Photo album - 1



Interior layout



sitting room



sitting room



view from the sitting-room



view from the sitting-room

Photo album - 2



bedroom



view from the bedroom



dining area



kitchen



kitchen



dining area



view from the kitchen



bathroom



the apartment house/building



roof terrace



summer living area



Single family home

Photo album - 3



Single family home

Single family home

overall view



Single family home

Single family home

view over a pedestrianized street

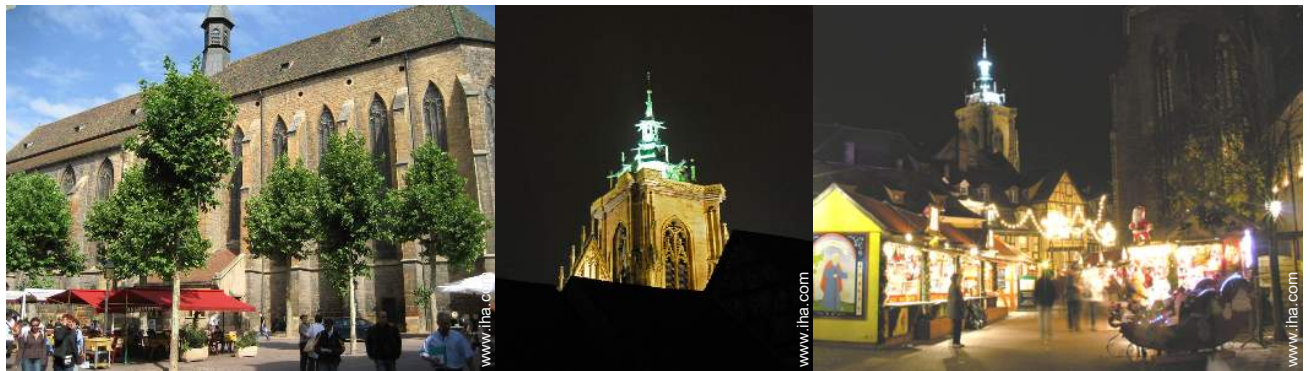

view from the house

view from the roof terrace

view over a pedestrianized street



view over the square

Winter

Summer

Advert No. 41458

www.iha.com



Internet
Holiday
Ads



Internet
Holiday
Ads



Route map

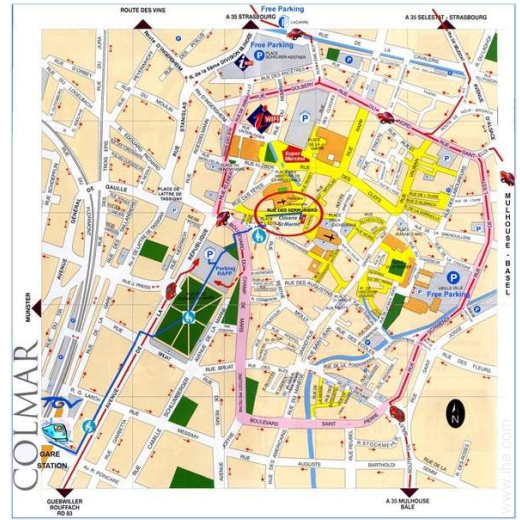

Location & Access



GPS coordinates in degrees, minutes, seconds: Latitude 48° 4'40.41"N - Longitude 7°21'26.12"E (Dwelling)

Address

→ 7 rue des Serruriers
68000 Colmar

• Freeway (exit) A35

→ Colmar, Upper Rhine, Alsace, France
→ Distance : 0.62mi.
→ Time : 5'

• Railroad station Colmar

→ Colmar, Upper Rhine, Alsace, France
→ Distance : 0.5mi.
→ Time : 5'

• Aerodrome Mulhouse Bâle

→ Mulhouse, Upper Rhine, Alsace, France
→ Distance : 37,3mi.
→ Time : 30'

- Riquewihr : Distance : 9mi.
- Strasbourg : Distance : 46,5mi.
- Basel : Distance : 37,3mi.

Contact

Last Name	Miss DEUTSCHMANN Jeannine
Address	1 rue George Sand
City	68000 COLMAR
Country	France
Phone #	+33 (0) 3 89 41 65 79 (France)
Cell phone #	+33 (0) 6 30 70 79 15 (France)
Cell phone2 #	+33 (0) 6 68 71 89 28 (France)

Spoken languages



Vacation rental
Upper Rhine - Alsace
"Closerie de la Collégiale St Martin - CA"

9

[Book now](#)

Availability calendar - from : may 2012

May	Tu	W	Th	F	Sa	Su	M	Tu	W	Th	F	Sa	Su	M	Tu	W	Th	F	Sa	Su	M	Tu	W	Th	F	Sa	Su	M	Tu	W	Th	
2012	1	2	3	4	5	6	7	8	9	10	11	12	13	14	15	16	17	18	19	20	21	22	23	24	25	26	27	28	29	30	31	





June	F	Sa	Su	M	Tu	W	Th	F	Sa	Su	M	Tu	W	Th	F	Sa	Su	M	Tu	W	Th	F	Sa							
2012	1	2	3	4	5	6	7	8	9	10	11	12	13	14	15	16	17	18	19	20	21	22	23	24	25	26	27	28	29	30
	-	-	-	-	-	-	-	-	-	-	-	-	-	-	-	-	-	-	-	-	-	-	-	-	-	-	-	-	-	-

Jul	Su	M	Tu	W	Th	F	Sa	Su	M	Tu	W	Th	F	Sa	Su	M	Tu	W	Th	F	Sa	Su	M	Tu							
2012	1	2	3	4	5	6	7	8	9	10	11	12	13	14	15	16	17	18	19	20	21	22	23	24	25	26	27	28	29	30	31
	-	-	-	-	-	-	-	-	-	-	-	-	-	-	-	-	-	-	-	-	-	-	-	-	-	-	-	-	-	-	

 Reserved  Mid season

[Month : Next >>](#)

Rental rates - Apartment-Flat - 4 Person(s)

Rates	Night	Weekend	week	2 weeks	Month
 Low season	\$95 * > 3	-	\$545 * (Saturday)	-	-
 Mid season	\$109 * > 3	-	\$613 * (Saturday)	-	-
 High season	\$123 * (Saturday) > 3	-	\$681 * (Saturday)	-	-
 Festive specials	\$136 * > 3	-	\$818 * (Saturday)	-	-

(Check-in day) > Minimum Night

[Book now](#)

Advert No. 41458

www.ihacom.com



Internet
Holiday
Ads



Internet
Holiday
Ads





sitting room

view from the sitting-room

view from the sitting-room



Interior layout

sitting room

Booking conditions

• **Reservation**

→ Payment made at time of reservation : 30% of rental sum
→ Payment balance : on return of keys

• **Rental**

→ Service charges included
→ Day tax included
→ Cleaning charge levy on departure : \$48 *
→ Anticipated supplement for :
- supplementary bed(s)

Accepted methods of payment

• Bank transfer (wire) • Check • Draft • Cash

[▶ Book now](#)

[▶ Contact the owner](#)

Contact directly the property owners

www.ihacom.com
Advert No.
41458
>> Book now <<

Contact

Last Name	Miss DEUTSCHMANN Jeannine
Address	1 rue George Sand
City	68000 COLMAR
Country	France
Phone #	+33 (0) 3 89 41 65 79 (France)
Cell phone #	+33 (0) 6 30 70 79 15 (France)
Cell phone2 #	+33 (0) 6 68 71 89 28 (France)

Spoken languages



* Converted at the rate indicated : €100 = \$136.26 = £86.8

Advert No. 41458

www.ihacom.com



Internet
Holiday
Ads



Internet
Holiday
Ads

