

Gîte - Self Catering Guifões House



Gîte - Self Catering - House,
attached home, 1 floor, separate
entrance

Setting : country setting, tranquil

Capacity : 6 person(s)

Bedroom(s) : 2

Room(s) : 3

Guifões - Porto District - North

Portugal

Advert No. 31400

Reservation : +33 (0) 254704921 (France)



www.ihha.com



Internet
Holiday
Ads



Internet
Holiday
Ads



Gîte - Self Catering



Gîte - Self Catering - House, attached home, 1 floor, separate entrance

- **Ideal for all age groups**
- **View :** country side, courtyard, village
- **Setting :** country setting, tranquil
- **Exposure :** South-west

Goodies

- **Parking :**
Parking uncovered
- **Advantages :**
3 bike(s)



façade

Surroundings & location



Ocean

Leisure

- **Leisure activities less than 12 miles :**

Bathing, scuba diving, water skiing, jet ski, surfing, windsurfing, tennis, riding school, pathway/broadwalk, coastal/forest paths, hiking, mountain bike (path), boat trips, horse trekking, rollerblade/rollerskate (circuit), fishing, fishing, pétanque field

- **Attractions and relaxation :**

Bar/pub, discotheque, restaurant, movie theater, karaoke, park and garden, zoo/animal park, sea world, exhibition center, art gallery, historical site, museum, theater, opera house, festivals, antiques & bric-a-brac, local craftstore, cellar and wine tasting, casino, sauna, steam baths, health spa

Surroundings

- **Locality :**

- Sea/ocean 3mi.
- Sandy beach 3mi.
- Public swimming pool 0.3mi.
- Forest 330'

- **Amenities :**

- Kindergarten 0.3mi.
- Village center 330'
- Downtown 0.3mi.
- Bus stop / bus station 330'
- Subway station 0.3mi.
- Bus pick up point beach 330'
- Car rental 6mi.
- Breadstore 330'
- Caterer 330'
- Local stores 330'
- Supermarket 1.85mi.
- High class retailers 3mi.
- Hairdressing salon 0.3mi.
- Internet cafe 0.3mi.
- Mail office 0.3mi.
- Bank 0.3mi.
- ATM 0.3mi.
- Drugstore 0.3mi.
- Doctor 0.3mi.
- Nurse 0.3mi.
- Hospital 3mi.



yard seated area



terrace



kitchen

Interior

- **Receive up to guest(s) :**
6 person(s) - 4 adults, 2 kids
- **Liveable floor area :**
485 Sq.ft.
- **Interior layout :**
3 Room(s), 2 bedroom(s), 1 shower room, 1 washroom, living room 215 Sq.ft., american style kitchen
- **Sleeps - bed(s) :**
2 full bed(s), 1 bunk beds
- **Guest facilities :**
T.V., vcr, t.v points, cable/satelite, wardrobe, Hanging wardrobe, hair dryer, mobile cool air fan, ceiling paddle fan, electric heating, Drapes, Rolling shutters
- **Appliances :**
Crockery/flatware, kitchen utensils, electric espresso coffee maker, electric kettle, toaster, juicer, gaz stove, oven, micro-wave oven, refridgerator, washing machine, vacuum cleaner, iron, ironing board

Exterior

- **Outside accommodation :**
Terrace 323 Sq.ft.
- **Outside amenities :**
BBQ, 6 yard seat(s), parasol, yard seated area, 2 chaise(s) longue(s)



kitchen

Services

- **washing :**
Sheets (1 X / per week), Towels (1 X / per week), Linen (1 X / per week), Comforter(s) (1 X / per week), Pillows (1 X / per week)
- **Single family home :**
Cleaning on departure supplement (+\$63 *), Parking

For your guidance

- **For your guidance**
Kids welcome
Pets accepted under certain conditions (ask the owner)
Non smoking rental, cell phone network coverage
Water : hot/cold
Local voltage supply : 220-240V / 50Hz
Electricity supply : mains



kitchen

Floor plan

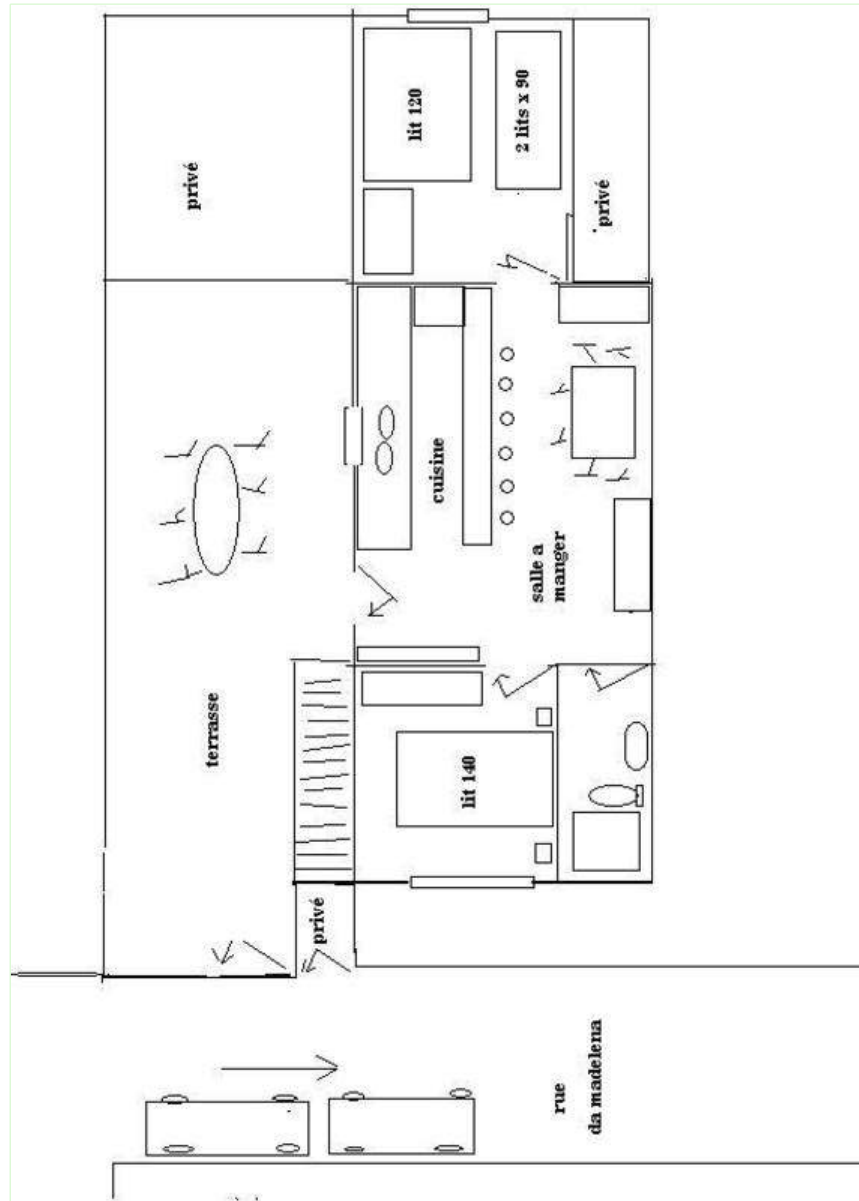

www.ihacom.com

Photo album - 1



terrace



yard seated area



façade



kitchen



kitchen

Photo album - 2



kitchen



kitchen utensils



living room



living room



living room



master bedroom



master bedroom



master bedroom



view from the bedroom



shower room

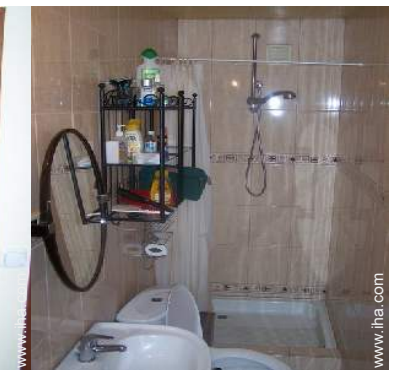

washroom

Photo album - 3



bunk beds



bedroom



bedroom



Leisure facilities



bike(s)



bike(s)



bike(s)



view from the terrace



Single family home



Parking

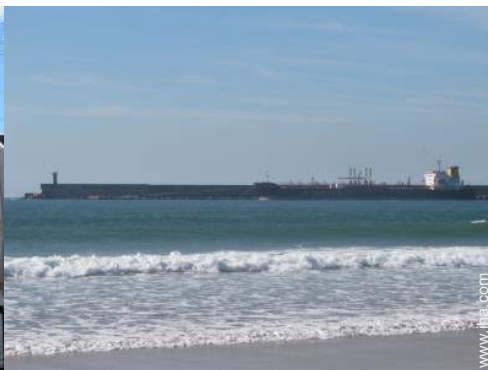

bathing

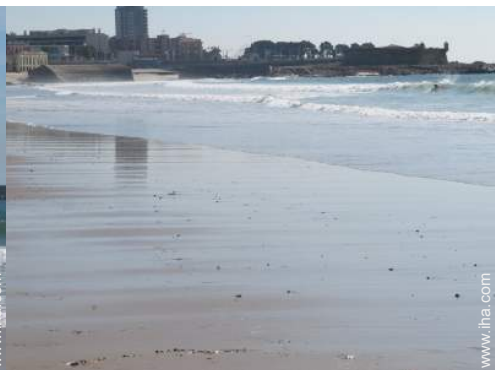

bathing

Route map

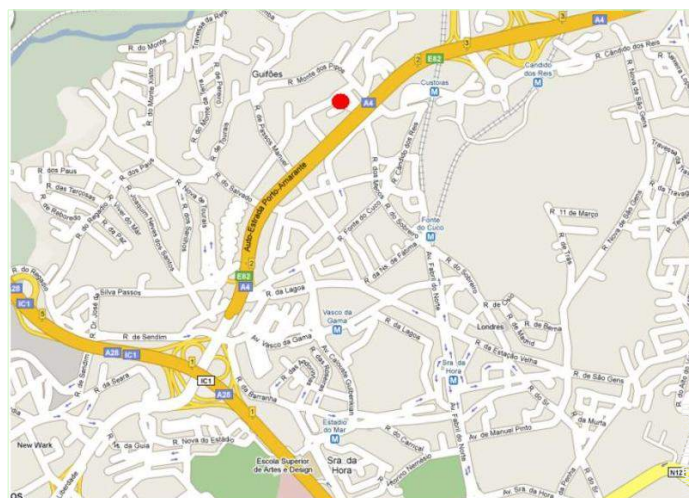

Location & Access



GPS coordinates in degrees, minutes, seconds: Latitude 41° 11'59"N - Longitude 8°39'38"W ([Dwelling](#))

Address

→ 27 Rua da Madelena
4460 Guifões

• Freeway (exit) A4 Custóias

→ Custóias, Porto District, North, Portugal
→ Distance : 0.62mi.
→ Time : 5'

• Airport Porto Francisco Sá Carneiro

→ Porto, Porto District, North, Portugal
→ Distance : 6mi.
→ Time : 30'

• Railroad station Custóias

→ Custóias, Porto District, North, Portugal
→ Distance : 0.3mi.
→ Time : 5'

• Porto : Distance : 4.5mi.

Contact

Last Name	Mr. MATOS Francis
Address	18 Rue Nationale
City	41120 CELLETES
Country	France
Phone #	+33 (0) 254704921 (France)
Cell phone #	+33 (0) 680701011 (France)

Spoken languages



Availability calendar - from : may 2012

May	Tu	W	Th	F	Sa	Su	M	Tu	W	Th	F	Sa	Su	M	Tu	W	Th	F	Sa	Su	M	Tu	W	Th	F	Sa	Su	M	Tu	W	Th	
2012	1	2	3	4	5	6	7	8	9	10	11	12	13	14	15	16	17	18	19	20	21	22	23	24	25	26	27	28	29	30	31	

June	F	Sa	Su	M	Tu	W	Th	F	Sa	Su	M	Tu	W	Th	F	Sa	Su	M	Tu	W	Th	F	Sa							
2012	1	2	3	4	5	6	7	8	9	10	11	12	13	14	15	16	17	18	19	20	21	22	23	24	25	26	27	28	29	30
	-	-	-	-	-	-	-	-	-	-	-	-	-	-	-	-	-	-	-	-	-	-	-	-	-	-	-	-	-	-

Jul	Su	M	Tu	W	Th	F	Sa	Su	M	Tu	W	Th	F	Sa	Su	M	Tu	W	Th	F	Sa	Su	M	Tu							
2012	1	2	3	4	5	6	7	8	9	10	11	12	13	14	15	16	17	18	19	20	21	22	23	24	25	26	27	28	29	30	31
	-	-	-	-	-	-	-	-	-	-	-	-	-	-	-	-	-	-	-	-	-	-	-	-	-	-	-	-	-	-	

Reserved

[Month : Next >>](#)

Rental rates - Gîte - Self Catering - House - 6 Person(s)

Rates	Night	Weekend	week	2 weeks	Month
<input type="checkbox"/> Low season	-	-	\$566 * (Saturday)	\$1007 * (Saturday)	-
<input type="checkbox"/> Mid season	-	-	\$566 * (Saturday)	\$1007 * (Saturday)	-
<input type="checkbox"/> High season	-	-	\$566 * (Saturday)	\$1007 * (Saturday)	\$1888 * (Saturday)

(Check-in day)

[Book now](#)





façade



kitchen



kitchen



terrace



yard seated area

Booking conditions

• Reservation

- Payment made at time of reservation : 50% of rental sum
- Payment balance : on return of keys
- Deposit required : \$378 *

• Rental

- Service charges to be added
- Day tax included
- Cleaning charge levy on departure : \$63 *
- Anticipated supplement for :
 - animals

[▶ Book now](#)

[▶ Contact the owner](#)

Contact directly the property owners

www.ihacom.com

Advert No.

31400

[>> Book now <<](#)

Accepted methods of payment

- Bank transfer (wire) • Check • Cash

Contact

Last Name	Mr. MATOS Francis
Address	18 Rue Nationale
City	41120 CELLETES
Country	France
Phone #	+33 (0) 254704921 (France)
Cell phone #	+33 (0) 680701011 (France)

Spoken languages



* Converted at the rate indicated : €100 = \$125.87 = £80.11

Advert No. 31400

www.ihacom.com



Internet
Holiday
Ads



Internet
Holiday
Ads

