

# Luxury vacation rental Châtel "Chalet Rose"



Luxury Mountain Chalet, detached,  
3 floors, separate entrance, in(on) a  
(an) Private property

Setting : ski to door, luxuriant

Capacity : 16 person(s)

Bedroom(s) : 7

Châtel - Upper Savoy (74) - Rhône Alpes

France

Advert No. 10554

Reservation : +31 (0) 346554007 (Netherlands)

[www.iha.com](http://www.iha.com)



Internet  
Holiday  
Ads



Internet  
Holiday  
Ads



### Luxury vacation rental



Luxury Mountain Chalet, detached, 3 floors, separate entrance, in(on) a(an) Private property

- **Ideal for family groups, all age groups**
- **View :** panoramic, dominant, mountain, country side, farmland, forest
- **Setting :** ski to door, luxuriant

### Goodies

- **Tennis :**  
Shared tennis, Surface clay
- **Parking :**  
Covered parking : carport  
Parking uncovered : off road
- **Advantages :**  
Ski locker, ski boot warmer, pool table, darts, ping-pong table, ping-pong bats
- **baby equipment :**  
High chair, comfort station, infant tub, baby potty, playpen

### Surroundings & location



Mountain



Ski

#### Leisure

- **Leisure activities less than 12 miles :**

Alpine skiing, cross-country skiing, off-piste skiing, ski-trekking, Télémart skiing, snowboarding, golf, tennis, hiking, rock climbing, hang-gliding, ATV/Quad Bike

- **Supervised :**

Ski school, kids ski area

- **Attractions and relaxation :**

Bar/pub, restaurant, movie theater

#### Surroundings

- **Locality :**

- Ski slopes 660'
- Ski lifts 660'
- Sandy beach 25mi.
- Shingle beach 25mi.
- Public swimming pool 1.25mi.
- Public tennis court 1.85mi.
- 9 hole golf course 25mi.
- Waterfall 0.62mi.
- Lake 1.25mi.
- Mountain range 165'

- **Amenities :**

- Village center 0.93mi.
- Downtown
- Ski hire store 660'
- Breadstore 1.25mi.
- Supermarket 1.5mi.
- Internet cafe 1.25mi.
- ATM 1.25mi.
- Drugstore 1.25mi.
- Doctor 1.25mi.



Fireplace



Ski



overall view

Advert No. 10554

www.iha.com



Internet  
Holiday  
Ads



Internet  
Holiday  
Ads





ski lifts

### Exterior

- **Size of grounds :**  
6,500 Sq.ft.
- **Outside accommodation :**  
Terrace, covered terrace, balcony
- **Outside setting :**  
Lawn
- **Outside amenities :**  
BBQ



Luxury Mountain Chalet

### Interior

- **Receive up to guest(s) :**  
16 person(s) - 16 adults
- **Liveable floor area :**  
2,370 Sq.ft
- **Interior layout :**  
7 bedroom(s), sleeping den, 4 bathroom, 1 washroom, living room 650 Sq.ft., sitting room, large american style kitchen, dining room, dining area, tv den, reception hall, laundry room
- **Sleeps - bed(s) :**  
6 full bed(s), 5 twin bed(s), 1 baby cradle
- **Guest facilities :**  
Fireplace, T.V., DVD player, book collection, wifi (wireless internet access), radio alarmclock, heated towel rail, fully air-conditioned, central heating, Double glazed
- **Appliances :**  
Crockery/flatware, kitchen utensils, electric coffee maker, electric kettle, toaster, juicer, electric stove, oven, micro-wave oven, refridgerator, deep freeze, dish washer, washing machine, clothes dryer, vacuum cleaner

### Services

- **washing :**  
Sheets supplement (+\$11 \*), Towels supplement (+\$11 \*), Linen supplement (+\$3 \*), Pillows
- **Single family home :**  
Cleaning on departure supplement (+\$252 \*), Snow clearance, Caretaker/ concierge, Parking, Airport transfers supplement (+\$189 \*)
- **Personnel :**  
Baby sitting supplement (+\$25 \*)

### For your guidance

- **For your guidance**  
Kids welcome  
Non smoking rental, cell phone network coverage, personal transport advisable  
Water : hot/cold  
Local voltage supply : 220V / 60Hz  
Electricity supply : mains



view from the balcony

Floor plan

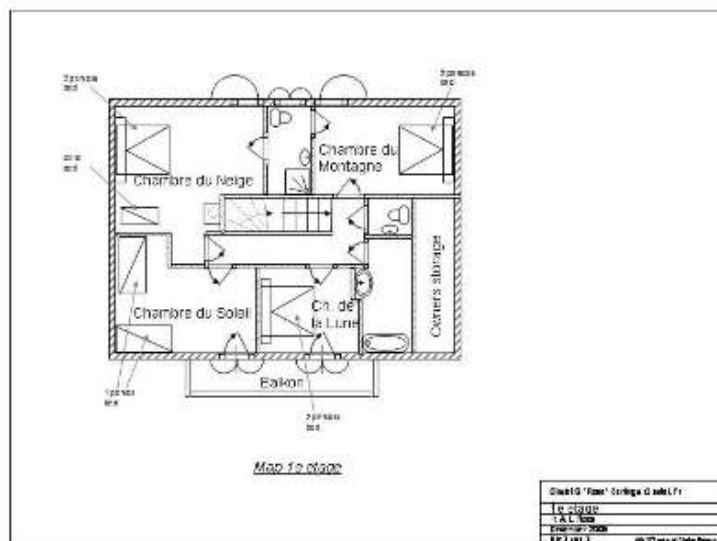
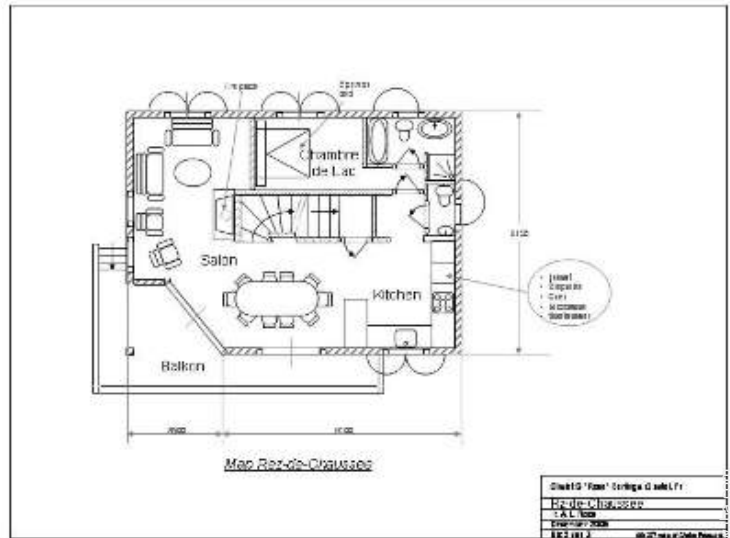
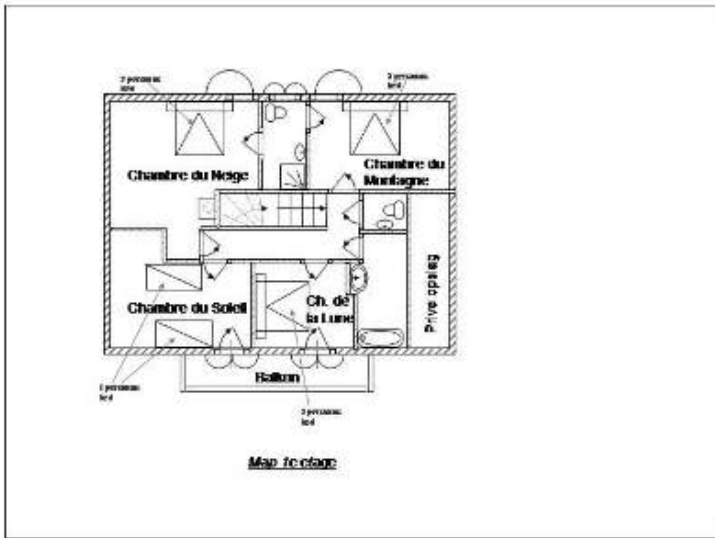
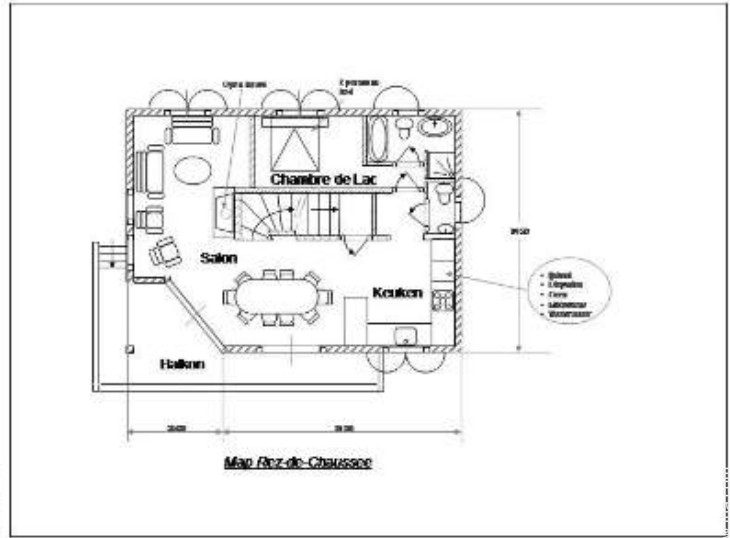
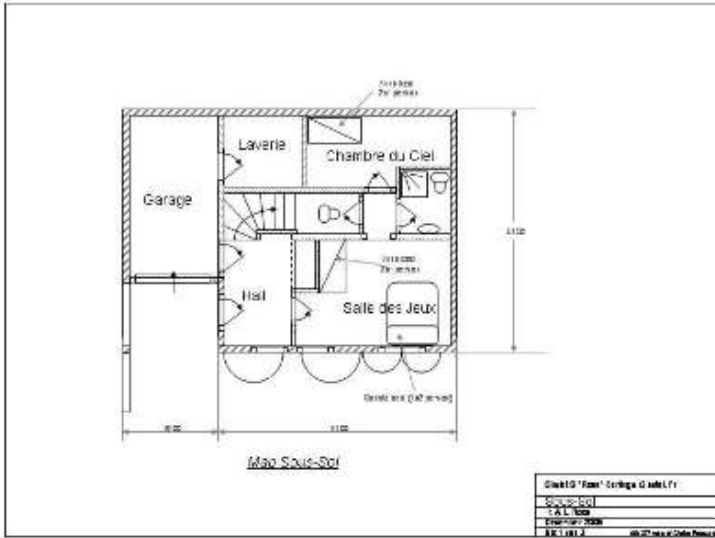

Photo album - 1



view from the house



overall view



Fireplace



Ski



ski lifts



view from the balcony

Photo album - 2



Luxury Mountain Chalet



bedroom



view from the bedroom



guest bedroom



sitting room



large american style kitchen



dining room



living room



Summer



dominant view



view from the living room



ping-pong table

Route map

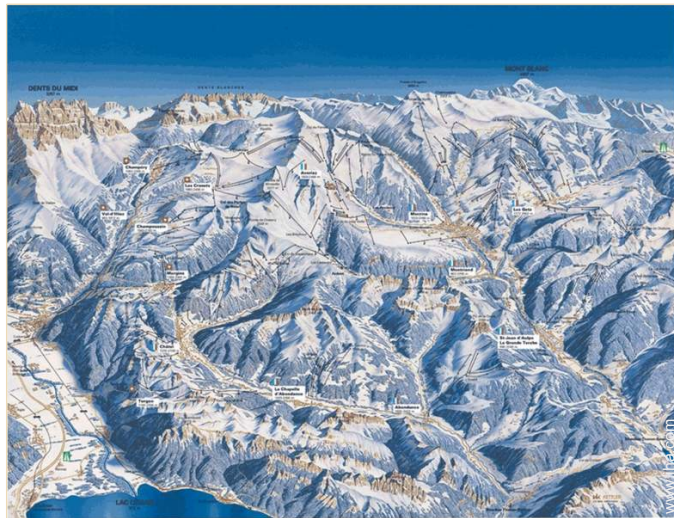
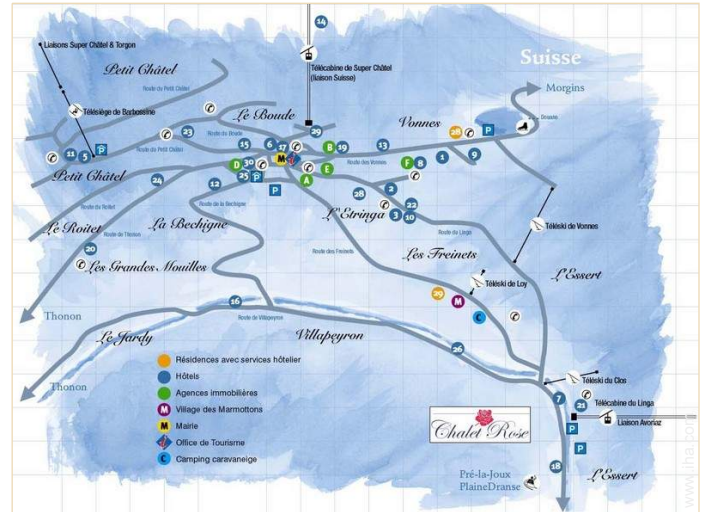

Location & Access



GPS coordinates in degrees, minutes, seconds: Latitude 46°15'13"N - Longitude 6°49'0"E ([Dwelling](#))

Address

→ Route pre la joux  
74390 Châtel

• [Airport Genève](#)

→ Geneva, Geneva Canton, Switzerland  
→ Distance : 90mi.  
→ Time : 1h45'

- Abondance : Distance : 3mi.
- Morgins : Distance : 1.85mi.
- Thonon les Bains : Distance : 21mi.

Contact

Last Name	Mr. Mrs. HERREMANS Scout
Address	Zandweg 31
City	3601 MAARSEN
Country	Netherlands
Phone #	+31 (0) 346554007 (Netherlands) From 08:00 AM to 09:00 PM (GMT/UTC)
Cell phone #	+31 (0) 623977277 (Netherlands)
Fax #	+31 (0) 847165483 (Netherlands)

Spoken languages



Luxury vacation rental  
Upper Savoy - Rhône Alpes  
"Chalet Rose"

8

[Book now](#)

Availability calendar - from : may 2012

May	Tu	W	Th	F	Sa	Su	M	Tu	W	Th	F	Sa	Su	M	Tu	W	Th	F	Sa	Su	M	Tu	W	Th	F	Sa	Su	M	Tu	W	Th	
2012	1	2	3	4	5	6	7	8	9	10	11	12	13	14	15	16	17	18	19	20	21	22	23	24	25	26	27	28	29	30	31	

June	F	Sa	Su	M	Tu	W	Th	F	Sa	Su	M	Tu	W	Th	F	Sa	Su	M	Tu	W	Th	F	Sa							
2012	1	2	3	4	5	6	7	8	9	10	11	12	13	14	15	16	17	18	19	20	21	22	23	24	25	26	27	28	29	30
	-	-	-	-	-	-	-	-	-	-	-	-	-	-	-	-	-	-	-	-	-	-	-	-	-	-	-	-	-	-

Jul	Su	M	Tu	W	Th	F	Sa	Su	M	Tu	W	Th	F	Sa	Su	M	Tu	W	Th	F	Sa	Su	M	Tu							
2012	1	2	3	4	5	6	7	8	9	10	11	12	13	14	15	16	17	18	19	20	21	22	23	24	25	26	27	28	29	30	31
	-	-	-	-	-	-	-	-	-	-	-	-	-	-	-	-	-	-	-	-	-	-	-	-	-	-	-	-	-	-	

■ Low season     
 ■ Mid season     
 ■ Reserved

[Month : Next >>](#)

Rental rates - Luxury Mountain Chalet - 16 Person(s)

Rates	Night	Weekend	week	2 weeks	Month
<span style="color: green;">■</span> Low season	-	-	\$1510 *	\$2266 *	-
<span style="color: lightblue;">■</span> Mid season	-	-	\$1888 * <i>(Saturday)</i>	\$3398 *	-
<span style="color: red;">■</span> High season	-	-	\$6545 * <i>(Saturday)</i>	-	-
<span style="color: magenta;">■</span> Festive specials	-	-	\$7552 * <i>(Saturday)</i>	-	-
<span style="color: orange;">■</span> Promotional period	-	-	\$3776 * <i>(Saturday)</i>	-	-

*(Check-in day)*

[Book now](#)





Ski



ski lifts



view from the balcony



view from the house



overall view



Fireplace

### Booking conditions

#### • Reservation

- Payment made at time of reservation : 50% of rental sum
- Payment balance : 3 weeks before the stay
- Deposit required : \$944 \*

#### • Rental

- Service charges included
- Day tax in addition
- Cleaning charge levy on departure : \$252 \*

[▶ Book now](#)

[▶ Contact the owner](#)

### Accepted methods of payment

- International Money Order

Contact directly the property owners

[www.iha.com](http://www.iha.com)

Advert No.

10554

>> [Book now](#) <<

### Contact

Last Name	Mr. Mrs. HERREMANS Scout
Address	Zandweg 31
City	3601 MAARSSSEN
Country	Netherlands
Phone #	+31 (0) 346554007 (Netherlands) From 08:00 AM to 09:00 PM (GMT/ UTC)
Cell phone #	+31 (0) 623977277 (Netherlands)
Fax #	+31 (0) 847165483 (Netherlands)

Spoken  
languages



\* Converted at the rate indicated : €100 = \$125.87 = £80.11

Advert No. 10554

[www.iha.com](http://www.iha.com)



Internet  
Holiday  
Ads



Internet  
Holiday  
Ads

